

# argoTrackPilot – quick start guide

## Preparation

1. Choose track from ECDIS or in Trackpilot

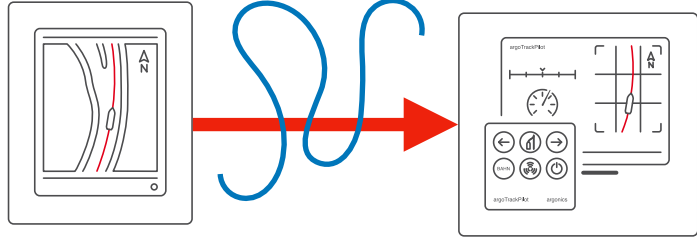

2. Choose profile



3. Set stream velocity

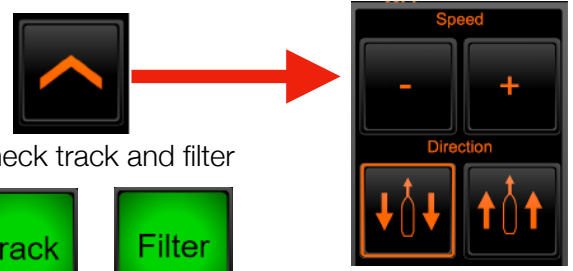

4. Check track and filter



5. Turn on trackpilot mode

## Oscillations

! Oscillations around guiding line

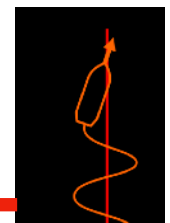

! Check stream settings

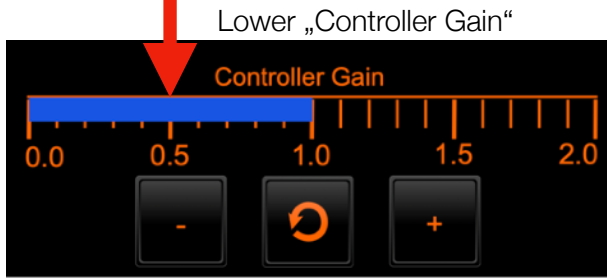

Test for a few minutes and adjust further if necessary

## Permanent track deviation

! Permanent track deviation

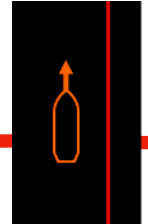

! Check stream settings



No

Autopilot reaches rate of turn setpoint and stays inside the valid range (blue)

Yes



1. Increase „Rudder“ on autopilot
2. Increase „Controller Gain“ on trackpilot
3. Check rate of turn signal

## Deviation in curves

! Check stream settings

Too far on inside of curve

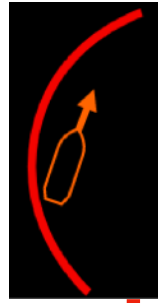

Too far on outside of curve

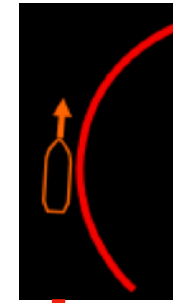

Change drift gain



Test for a few minutes and adjust further if necessary

## Miscellaneous

Checking system version



Open access for remote support

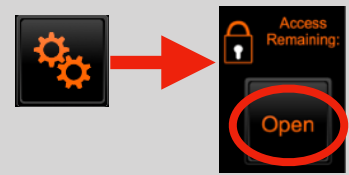

Restarting trackpilot (and touchscreen)



Variant B)

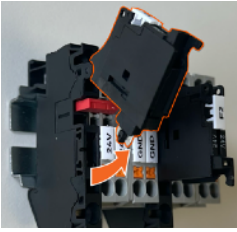

Watch alarm settings

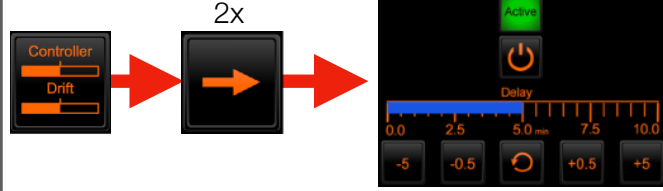

Download manual



Support Hotline:  
+49 711 25253721

# argoTrackPilot – warnings and alarms

Warning Name	Action	Alarm Name	Action
AIS: Error - Contact support	<ul style="list-style-type: none"> <li>• (Re-)Start the AIS.</li> <li>• If the warning does not disappear by itself, contact support.</li> </ul>	Autopilot connection lost: Take control	<ul style="list-style-type: none"> <li>• Switch off immediately</li> <li>• Check correct function of all devices</li> <li>• Contact customer support</li> </ul>
AIS: No data received	<ul style="list-style-type: none"> <li>• TargetPilot active? ➔ Closely monitor track control system for correct operation</li> <li>• Malfunction of AIS? ➔ immediately deactivate TargetPilot</li> </ul>	Collision ahead: Take control	<ul style="list-style-type: none"> <li>• Acknowledge alarm by switching to manual steering. There is no other way to acknowledge the alarm.</li> <li>• Continue to steer manually and avoid collision</li> <li>• In case of false alarm, check the setting of the argoLaneWarning</li> </ul>
Close to end of track	<ul style="list-style-type: none"> <li>• Switch to manual steering</li> <li>• Choose new guiding line</li> </ul>	End of track reached: Take control	<ul style="list-style-type: none"> <li>• Immediately switch to manual steering</li> <li>• Choose new guiding line</li> </ul>
Collision ahead	<ul style="list-style-type: none"> <li>• Move current track</li> <li>• Wait until the ship has reached the shifted line</li> </ul>	I/O: Error - Contact support	<ul style="list-style-type: none"> <li>• Switch off immediately</li> <li>• Check correct function of all devices</li> <li>• Contact customer support</li> </ul>
Distance to track large	<ul style="list-style-type: none"> <li>• Check if the autopilot system processes the commands by the track control system</li> <li>• Acknowledge warning</li> </ul>	Lock warning: Take control	<ul style="list-style-type: none"> <li>• Acknowledge alarm. Can only be done by deactivating the Trackpilot.</li> <li>• Continue manually.</li> </ul>
ECDIS / Alphanon Display: connection lost	<ul style="list-style-type: none"> <li>• (Re-)Start the ECDIS / Alphanon Display.</li> <li>• If this warning does not disappear by itself, contact support.</li> </ul>	Position unusable: Take control	<ul style="list-style-type: none"> <li>• Acknowledge alarm by switching to manual steering. There is no other way to acknowledge the alarm.</li> <li>• Wait until state of track control system returns to „READY“.</li> <li>• Check in ECDIS if ship position on map and reality match.</li> <li>• Switch on track control system</li> <li>• Increase attention</li> </ul>
End of SafetyContour ahead	<ul style="list-style-type: none"> <li>• Select new safety corridor</li> </ul>	Rudder change too large: Take control	<ul style="list-style-type: none"> <li>• Acknowledge alarm by switching to manual steering.</li> <li>• Wait until state of track control system returns to „READY“.</li> <li>• Check in ECDIS if ship position on map and reality match.</li> <li>• Switch on track control system</li> <li>• Increase attention</li> </ul>
GPS (2): No heading received	<ul style="list-style-type: none"> <li>• Acknowledge warning and closely monitor track control system for correct operation</li> <li>• Error persists after 10 minutes? ➔ Contact support, if nec. switch to manual steering</li> </ul>	System Error 001/002/003 - Contact support	<ul style="list-style-type: none"> <li>• Switch off immediately</li> <li>• Contact customer support</li> </ul>
GPS (2): No position received	<ul style="list-style-type: none"> <li>• Acknowledge warning</li> <li>• Closely monitor track control system for correct operation</li> <li>• Increase attention</li> <li>• Wait if data comes back</li> <li>• otherwise switch to manual steering</li> </ul>	Target lost: Take control	<ul style="list-style-type: none"> <li>• Acknowledge alarm by switching to manual steering. There is no other way to acknowledge the alarm.</li> <li>• Continue manually and select new AIS target or deactivate TargetPilot</li> </ul>
GPS (2): No velocity received	<ul style="list-style-type: none"> <li>• Acknowledge warning and closely monitor track control system for correct operation</li> <li>• Error persists after 10 minutes? ➔ Contact support, if nec. switch to manual steering</li> </ul>	Target too close: Take control	<ul style="list-style-type: none"> <li>• Acknowledge alarm</li> <li>• Continue manually and increase distance to AIS target or deactivate TargetPilot</li> </ul>
Left/Right limit violated	<ul style="list-style-type: none"> <li>• Move the track to keep the planned path within the safety corridor</li> </ul>	Track too far away	<ul style="list-style-type: none"> <li>• Switch to manual steering</li> <li>• Check if the correct guiding line has been chosen</li> <li>• Choose another line closer to the current position</li> </ul>
Lock warning	<ul style="list-style-type: none"> <li>• Pay close attention.</li> <li>• Adjust speed if necessary.</li> </ul>	Turn too sharp: Take control	<ul style="list-style-type: none"> <li>• Switch to manual steering</li> <li>• Check guiding line for errors (points very close together)</li> <li>• Choose new guiding line</li> </ul>
Lock warning not available	<ul style="list-style-type: none"> <li>• Contact customer service.</li> </ul>	Watch alarm: Take control	<ul style="list-style-type: none"> <li>• Acknowledge alarm by switching to manual steering.</li> <li>• Activate Trackpilot mode again</li> </ul>
No ROT received	<ul style="list-style-type: none"> <li>• Check the correct function of all devices.</li> <li>• If this warning does not disappear by itself, contact support.</li> </ul>		
Position inaccurate	<ul style="list-style-type: none"> <li>• Wait for the warning to disappear</li> <li>• If EstimationDegraded error comes up switch to manual steering</li> </ul>		
Power supply connected incorrectly	<ul style="list-style-type: none"> <li>• Contact dealer/installer</li> </ul>		
Strong cross current detected	<ul style="list-style-type: none"> <li>• Increase attention</li> </ul>		
Target close	<ul style="list-style-type: none"> <li>• Decrease velocity or deactivate TargetPilot or select different target</li> </ul>		
Target lost	<ul style="list-style-type: none"> <li>• Closely monitor track control system for correct operation</li> </ul>		
Trackpilot switched off	<ul style="list-style-type: none"> <li>• Activate Trackpilot again if required</li> <li>• Check correct function of all devices</li> </ul>		
Velocity low	<ul style="list-style-type: none"> <li>• Increase velocity</li> <li>• Acknowledge warning</li> </ul>		
Watch alarm: Activity required	<ul style="list-style-type: none"> <li>• Move Track or click any button on the touch display</li> </ul>		